

This document contains steps for connecting your Chromebook to the campus Wi-Fi network. Before attempting to connect, ensure that Wi-Fi is enabled, and that the wireless adapter is functioning correctly. The IT Services Help Desk can assist you in connecting to the Wi-Fi if you are experiencing an issue when following this guide, but cannot assist with diagnosing or repair of your Chromebook.

Note: Your computer must support 5 GHz Wi-Fi in order to connect to the campus network. Most computers manufactured in the last 5+ years have a 5 GHz radio. Note that older versions of ChromeOS did not support WPA2 Enterprise authentication, which is required in order to connect to the campus Wi-Fi.

1. Open the **Settings** app.

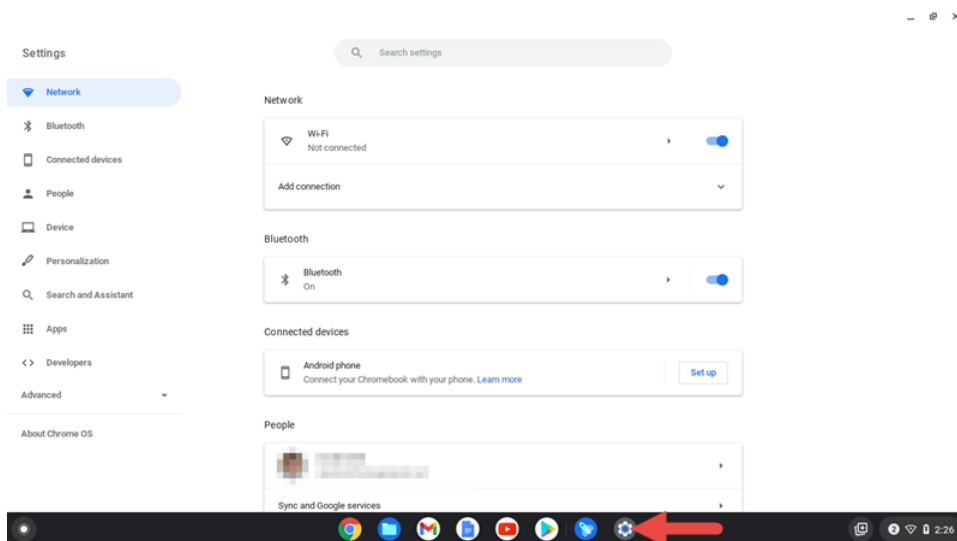

2. Click the Wi-Fi setting.

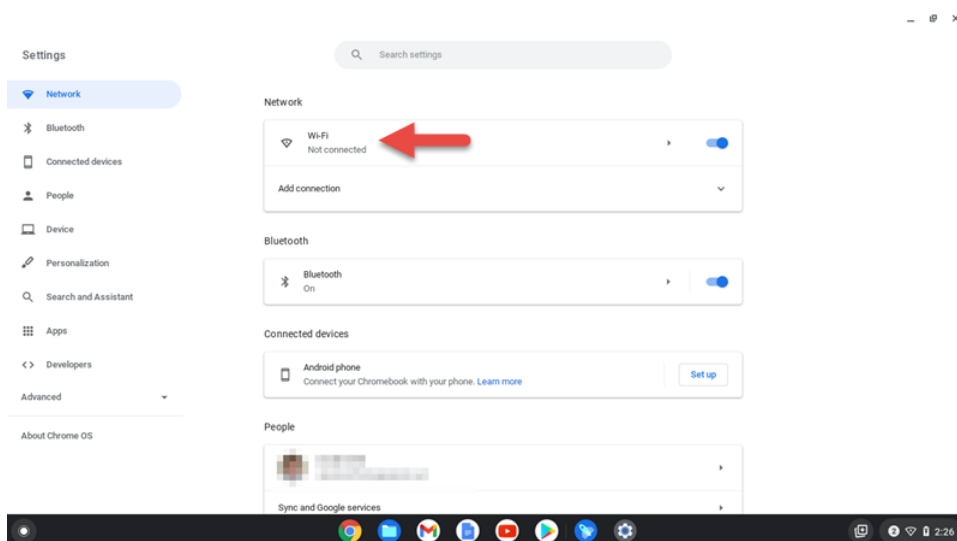

3. Click the *MMU-Community* network.

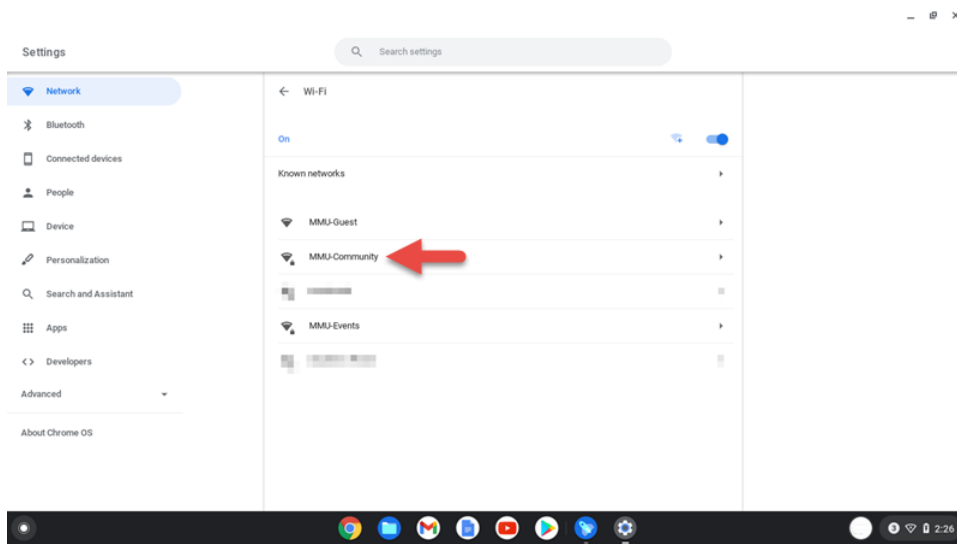

4. From the **EAP Method** dropdown, select *PEAP*.

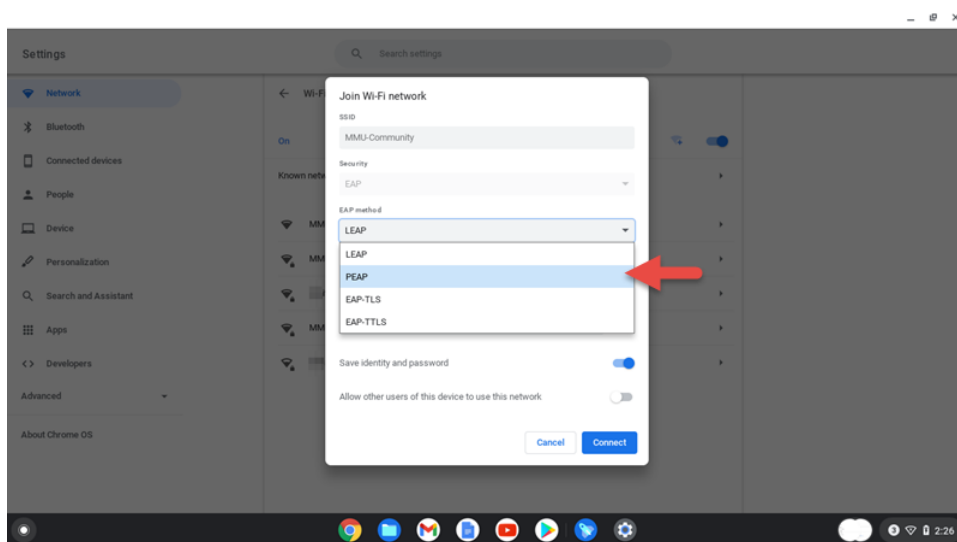

5. From the **EAP Phase 2 Authentication** dropdown, select *MSCHAPv2*.

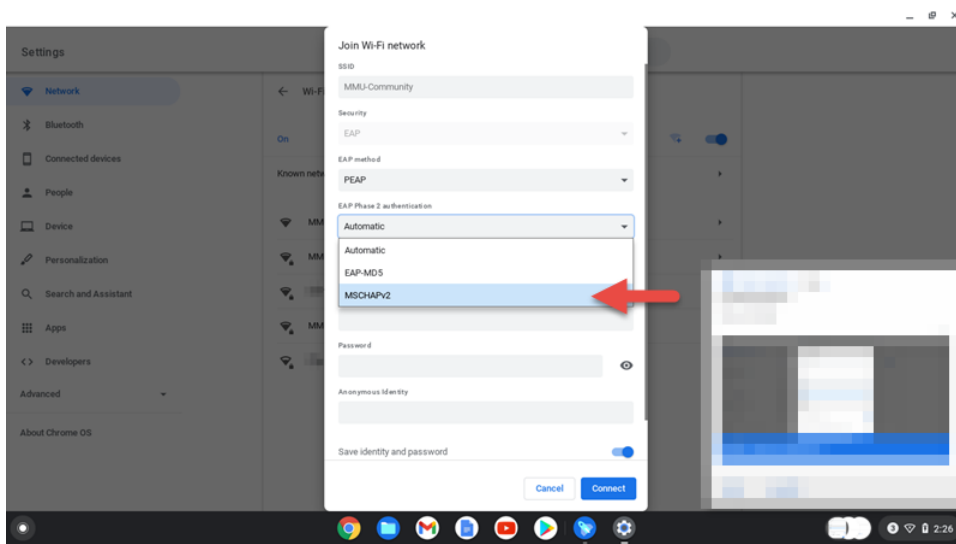

6. Enter your campus username – the portion of your email before *@mtmary.edu* – in the **Identity** box (1), and your campus password in the **Password** box (2). Then click **Connect** (3).

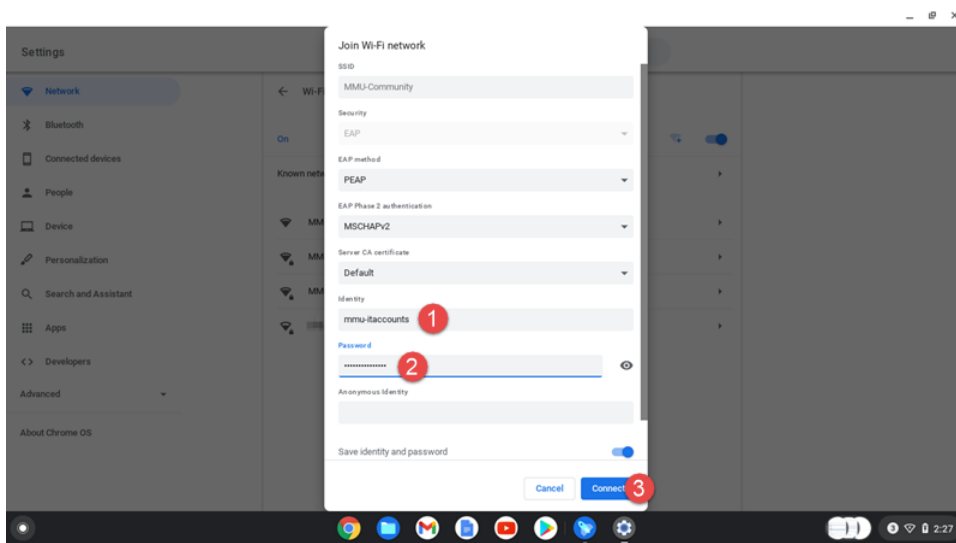

7. The network will briefly show that it is *Connecting...*

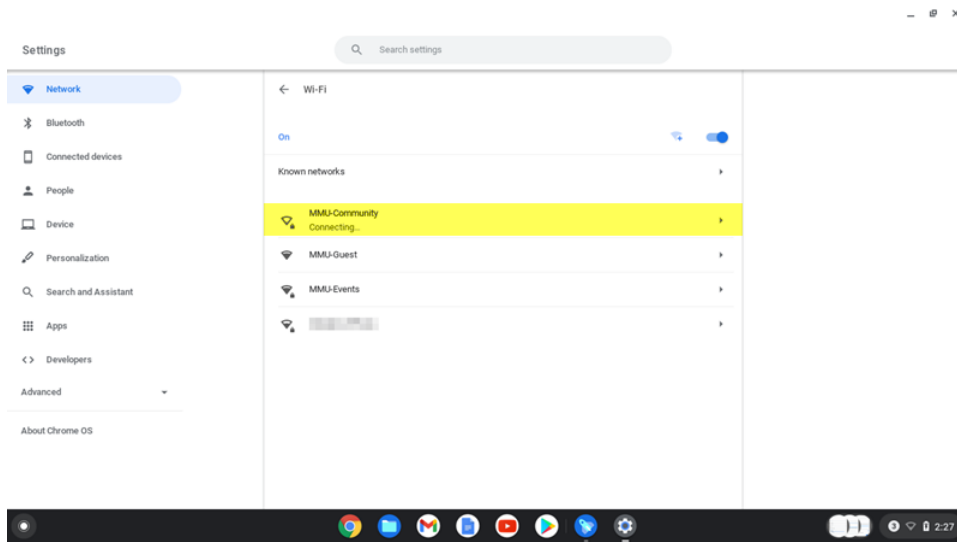

8. After a few moments, the network should show as *Connected*.

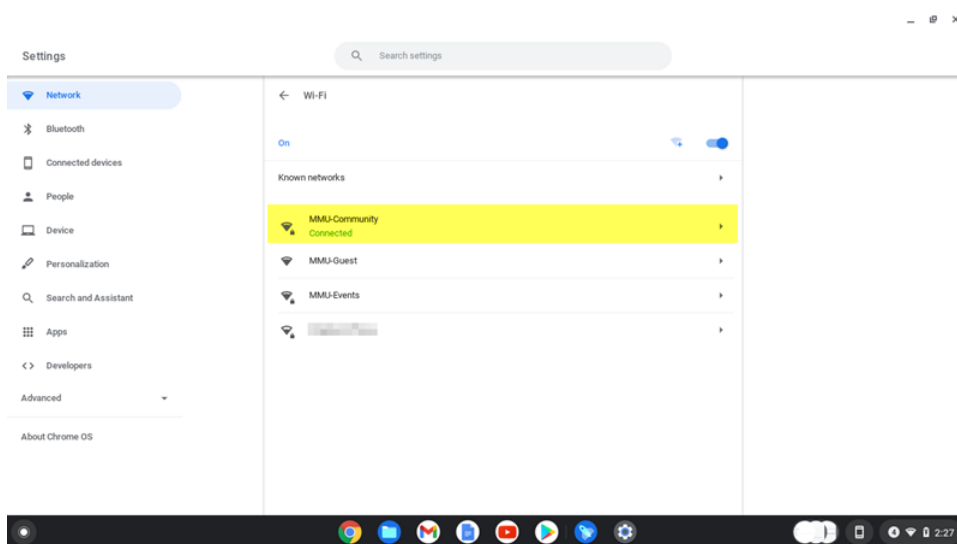

If you have any questions or experience any issues, please contact the IT Help Desk at 414-930-3048 (x3048 on campus) or mmu-helpdesk@mtmary.edu.